

Radio remote control IMET

Model **M550** Type **WAVE S8** Drawing ref. no. **1042**

Serial no. **32249741**

Machine

Brand

Model

Construction year

Serial no.

Installation date

Wiring connection made in compliance with the manufacturer's instructions.
Installation and start up tests perfectly carried out.
Installer's stamp and signature

It is important to complete the radio control wiring diagram connecting it to the machine to ensure correct installation.
For this reason, please fill in all the parts of the form below, writing in the boxes the reference number of the wires of the multicore cable connecting the radio control to the machine.

GHS



ENCLOSURE C

Title
M550SLAC RECEIVER CONNECTION DIAGRAM
M550SLDC WAVE S8-1042

Designer **RRTV** Date **28.05.07** Sheet **1/1**

Scale **1:1** Rev Number **00** Rev date **00.00.00**

File **M550SLDC.dwg**
Approved

Software RX
☐ H8 ☐ M550RX STD

Dip Switch
1 2 3 4
ON ☐ ☐ ☐ ☐
OFF ☐ ☐ ☐ ☒

Working Voltage
☐ 110Vac ☐ 230Vac

Antenna
☒ Int. ☐ On box ☐ Ext.
Software RTX

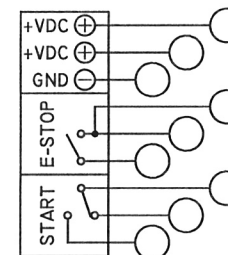
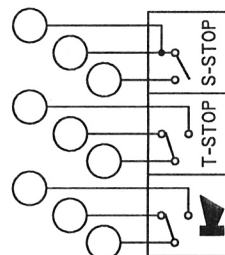
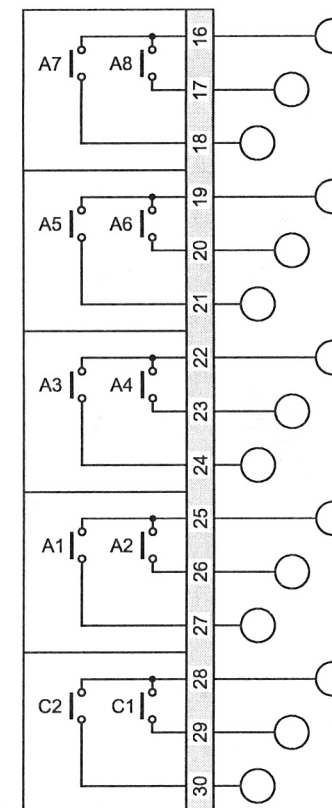
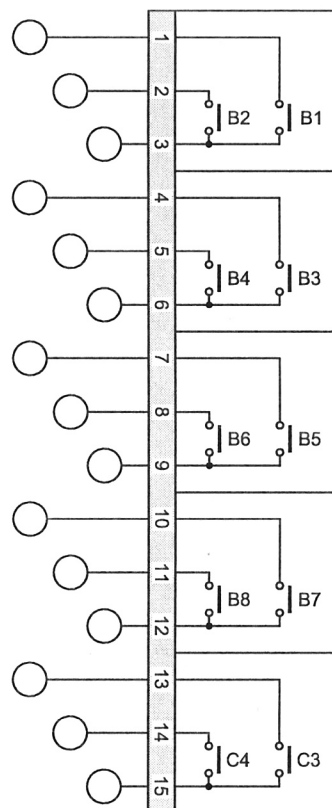

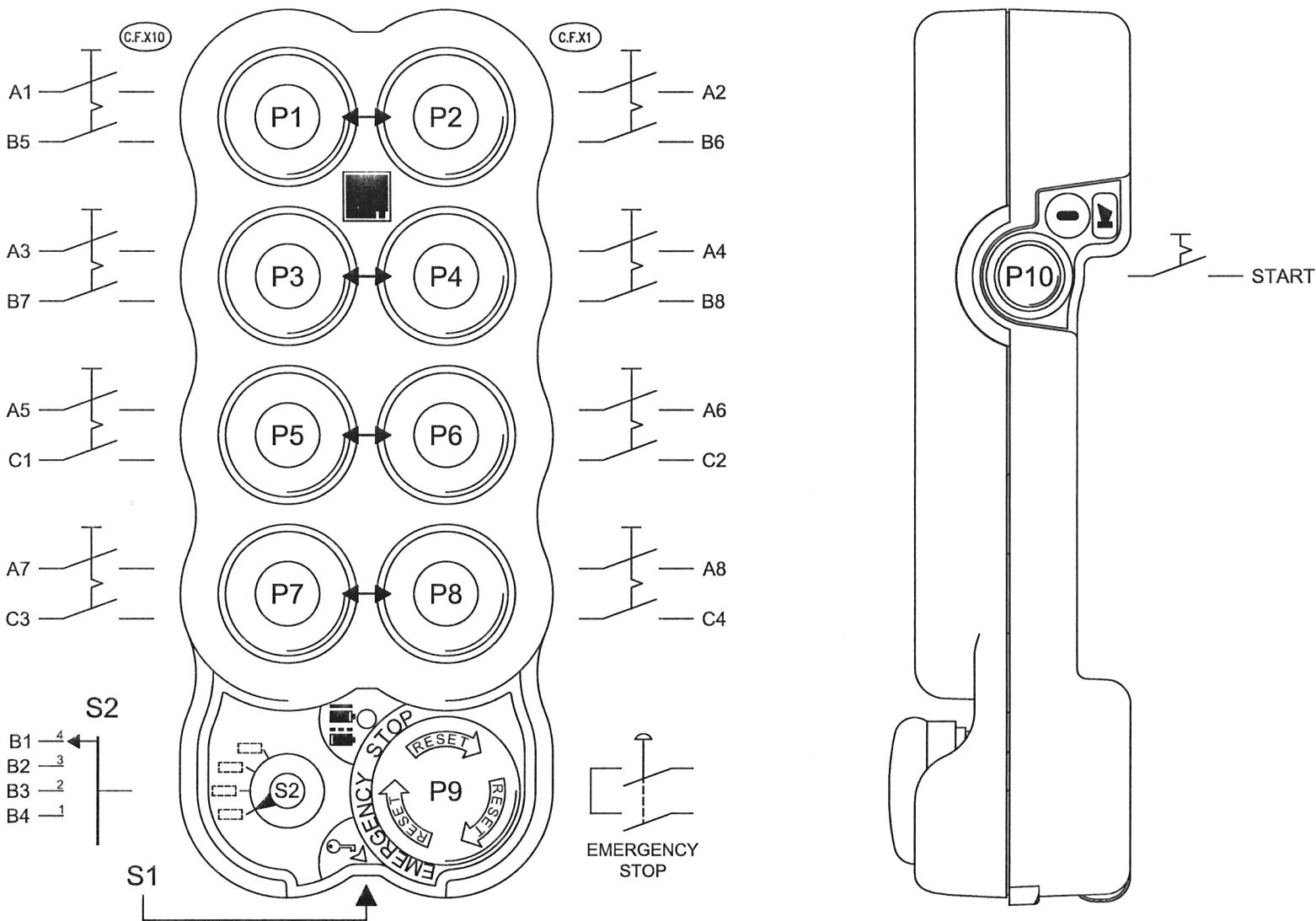

ENCLOSURE A

Title	
RADIO REMOTE CONTROL TYPE M550S WAVE S8-1042	
Designer	Date
RRTV	28.05.07
Sheet	Scale
1/1	1:1
Rev number	Rev date
00	00.00.00
File	
M550S WAVE S8-1042.dwg	

Approved

Software TX	
H8	M550TX STD
ST7	M550TX STD

Time Out TX	
3 min.	<input type="checkbox"/> Off
<input type="checkbox"/> NO Active Command	
<input checked="" type="checkbox"/> NO Command status variation	

Serial transmission	
<input type="checkbox"/> Yes	<input checked="" type="checkbox"/> No

Timed Stop	
<input checked="" type="checkbox"/> Delayed	
<input checked="" type="checkbox"/> Active Emerg.	
<input type="checkbox"/> Passive Emerg.	

NOTE :
S2
 CON comandi MASCHERATI allo START

GHS



THE PRESENT DOCUMENTATION BELONGS TO IMET.
 ITS REPRODUCTION AND SPREADING IS LEGALLY FORBIDDEN